

A VENUE AS INSPIRING  
AS ITS SURROUNDINGS

# WHISTLER

## CONFERENCE CENTRE



[WHISTLER.COM/MEETINGS](http://WHISTLER.COM/MEETINGS) | 1.855.938.2770



**WHISTLER**  
CONFERENCE CENTRE





# WHISTLER EVENTS: TRULY INSPIRING



Bring your team together in Whistler and experience an innovative and customizable venue. With \$3.5 million in facility upgrades, the Whistler Conference Centre is the signature group venue in Whistler, BC. The Centre's contemporary aesthetic, infused with West Coast character, compliments Whistler's natural environment. With hotels, restaurants and shops within walking distance, transportation logistics take care of themselves here. And, 40,000 square feet of versatile meeting space gives you and your group room to roam.

## NORTH AMERICA'S PREMIER MOUNTAIN DESTINATION

**Unique Pedestrian Village:** Located at the base of Whistler and Blackcomb mountains, Whistler Village is a pedestrian-friendly hub. You'll find a perfect mix of world-class and homegrown local shops and restaurants, all within walking distance from the Conference Centre.

**Award-Winning Hotels:** Whistler's diverse selection of accommodation, conveniently located in the Village, makes the transition from work to play to rest seamless. Finding the perfect accommodation is easy in Whistler.

## WORLD-CLASS FACILITIES

**State of the Art Lighting:** The Centre's unique architecture and natural features, including the beautiful wooded cathedral ceilings, are highlighted by dimmable LED lights. The large-scale custom copper light fixtures add drama and scale to the Grand Foyer and ballrooms, helping set the perfect ambiance for any event.

### High-Quality Finishes and Furnishings:

You'll feel the West Coast setting of the Whistler Conference Centre in every detail. Original local artwork animates the striking natural beauty of Whistler's natural landscapes. And, premium finishes like the custom maple meeting room doors, complete with RFID locks, cap off the Centre's elevated experience.

**Grand Foyer:** The naturally-lit Grand Foyer is set for hosting a show-stopping gathering. The 40-foot 3-sided wood-burning Rumford rock fireplace and the natural light from the skylights work together to create a relaxed ambiance. This cozy setting is the perfect place to discuss the day's meetings and start planning what trails to explore next.

**Ballroom:** Whistler's largest ballroom lets your ideas, from the wild to wonderful, come alive. Retractable blinds in the Sea to Sky Ballroom allow you to control the natural light during your event, increase your attendees' moods, and help them stay engaged.

You'll find a heightened quality of sound here, with the acoustic panels absorbing any echo in the ballroom. With reduced sound transmission to surrounding rooms, you and your group will avoid any distractions or background noise while digging into your next meeting. We can't promise your attendees won't be dreaming of the surrounding peaks, though.

**Scratch Kitchen:** Here, our Executive Chef focuses on seasonal cuisine, with locally grown, fresh products leading the way.

**Rainbow Theatre:** Home of the annual Whistler Film Festival, the 250-seat Rainbow Theatre boasts raised, built-in staging and the latest in theatre lighting, audio and digital video technology.

## LOCAL INSPIRATION

**Sustainability and Community:** Whistler is a leader in environmental practices and was proudly Canada's first destination to be awarded four APEX/ASTM certifications; Conference Centre, F&B Supplier, A/V Supplier & CVB/Destination. The Whistler Conference Centre is earth-friendly and part of a community-wide push towards sustainability.

Photos: Mike Crane, Andrew Doran, Brad Kasselmann, Joern Rohde



## LET US HELP YOU

Tourism Whistler is a full-service Convention & Visitors Bureau (CVB) and is your one-stop-shop for planning meetings, special events, retreats, tradeshow or any gathering in the spectacular surroundings of Whistler. The Conference Centre is managed and operated by Tourism Whistler.

**CALL 1.855.938.2770 OR VISIT US AT [WHISTLER.COM/MEETINGS](http://WHISTLER.COM/MEETINGS)**



# WHISTLER CONFERENCE CENTRE

## UPPER LEVEL

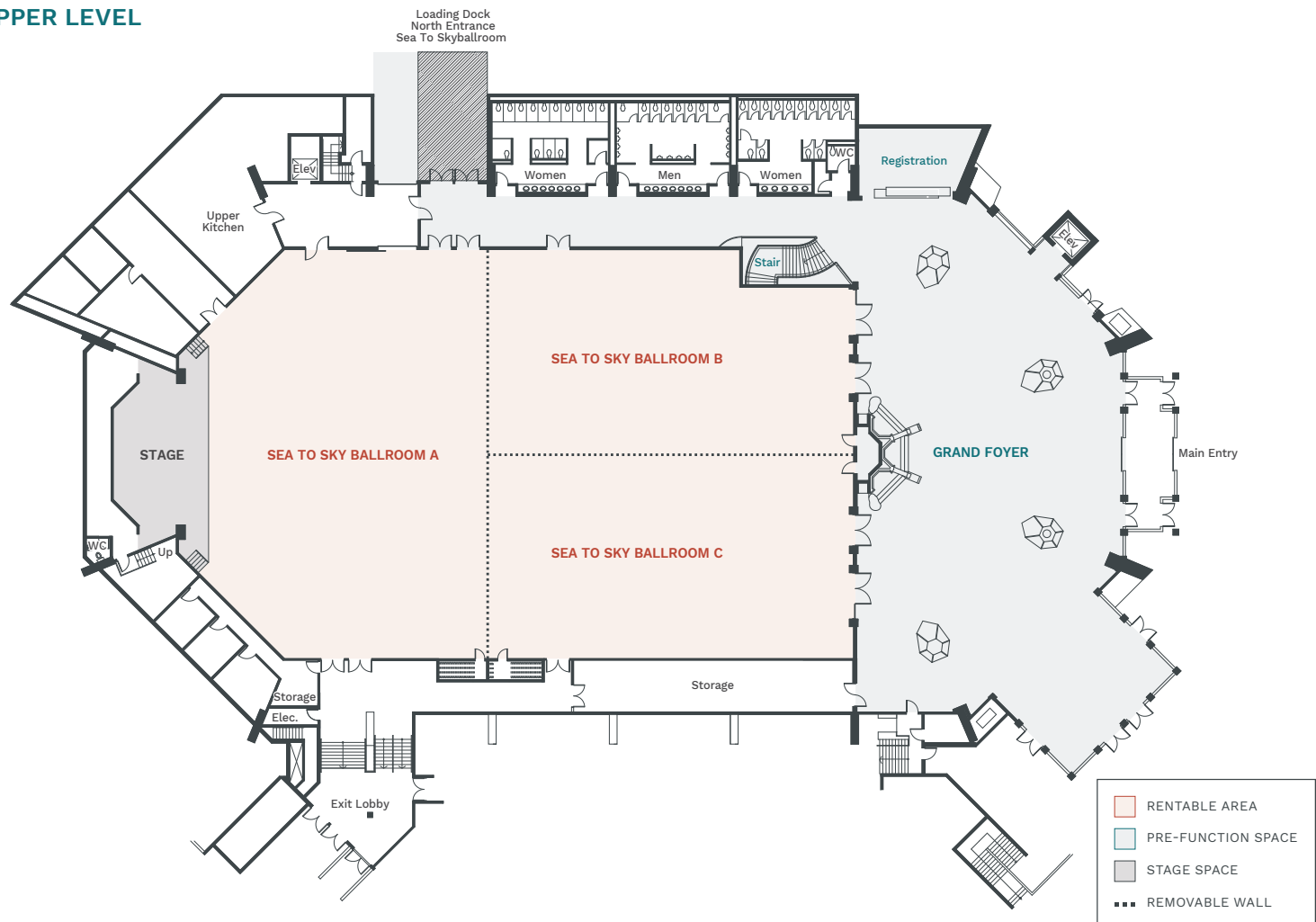

ROOM	THEATRE- STYLE	CLASSROOM	BOARDROOM	BANQUET (PLATED)			EXHIBIT BOOTH	RECEPTION	DIMENSIONS		AREA		CEILING HEIGHT	
		2-3 per table	hollow sq	u-shape	round x8	round x10	8x10		ft	m	sq ft	sq m	f	m
Sea to Sky Ballroom	1,600	644-966	n/a	n/a	1,056	1,320	100	1,600	164.5 x 104.5	50.1 x 31.9	16,500	1,532.9	15/32	4.5/9.6
Sky Ballroom A	680	252-378	n/a	n/a	432	540	42	690	70.11 x 104.5	21.4 x 31.9	7,032	653.3	15/32	4.5/9.6
Sky Ballroom B	440	168-252	n/a	n/a	296	370	27	440	93.2 x 52.1	28.4 x 15.9	4,565	424.1	15/32	4.5/9.6
Sky Ballroom C	470	168-252	n/a	n/a	312	390	27	470	93.2 x 52	28.4 x 15.9	4,845	450.1	15/32	4.5/9.6
Sky Ballroom B / C	920	392-588	n/a	n/a	600	750	54	920	93.2 x 104.5	27.8 x 31.9	9,410	874.2	15/32	4.5/9.6
Stage Area	n/a	n/a	n/a	n/a	n/a	n/a	n/a	n/a	24 x 36	7.3 x 11	864	80.3	11/17	3.6/5.2
Grand Foyer	525	n/a	n/a	n/a	364	460	19	800	56 x 116	17.1 x 35.4	6,530	606.7	15/32	4.5/9.6
Registration	n/a	n/a	n/a	n/a	n/a	n/a	n/a	n/a	7.5 x 23	2.2 x 6.6	172.5	14.52	n/a	n/a



## UNDER ONE ROOF

- ◆ 40,000 square feet of rentable meeting space
- ◆ 16,500 square foot ballroom with natural light
- ◆ 9,400 square feet of pre-function space
- ◆ 250 seat theatre
- ◆ 13 breakout rooms
- ◆ Proximity to hotels, restaurants and shops
- ◆ State-of-the-art lighting
- ◆ Artwork curated from local artists
- ◆ 3-sided wood burning Rumford fireplace
- ◆ 2 built-in raised stages
- ◆ 32 foot ceilings in ballroom
- ◆ Over 100 rigging points in ballroom
- ◆ Conference Centre-wide wireless internet access
- ◆ Direct access to underground parking
- ◆ Fully catered facility with top quality cuisine

LOWER LEVEL



ROOM	THEATRE- STYLE	CLASSROOM	BOARDROOM	BANQUET (PLATED)		EXHIBIT BOOTH	RECEPTION	DIMENSIONS		AREA		CEILING HEIGHT	
		2-3 per table	hollow sq	u-shape	round x8	round x10	8x10	ft	m	sq ft	sq m	f	m
Black Tusk	n/a	n/a	18	n/a	n/a	n/a	n/a	20.3 x 31.2	6.2 x 9.5	633	58.8	8	2.4
Fitzsimmons	135	60-90	48	46	88	110	8	35.11 x 43	10.7 x 13.1	1,510	140.3	9	2.7
Garibaldi	200	100-150	60	58	144	180	16	40 x 60	12.2 x 18.3	2,308	214.4	10	3
Garibaldi A	98	40-60	30	28	72	90	8	29.4 x 38.11	9 x 11.6	1,120	104.1	10	3
Garibaldi B	102	40-60	30	28	72	90	8	28.5 x 41.5	8.7 x 12.6	1,183	109.9	10	3
Harmony	160	76-114	50	48	96	120	12	35.11 x 52.3	10.7 x 15.9	1,836	170.6	9	2.7
Harmony A	72	24-36	24	22	48	60	6	35.11 x 26	10.7 x 7.9	913	84.8	9	2.7
Harmony B	72	24-36	24	22	48	60	6	35.11 x 26	10.7 x 7.9	913	84.8	9	2.7
Rainbow Theatre	250	250	n/a	n/a	n/a	n/a	n/a	n/a	n/a	3,300	306.6	17	5
Stage Area	n/a	n/a	n/a	n/a	n/a	n/a	n/a	13.9 x 38	4.2 x 11.6	528.2	48.7	14	4.2
Soo Valley	20	10-15	12	10	24	30	n/a	16.8 x 22.1	5.1 x 6.7	371	34.5	9	2.7
Spearhead	70	20-30	26	24	48	60	n/a	38.6 x 22.2	11.8 x 6.8	857	79.6	9	2.7
Spearhead A	30	10-15	12	10	24	30	n/a	17.6 x 22.2	5.4 x 6.8	391	36.3	9	2.7
Spearhead B	30	10-15	14	12	24	30	n/a	20.9 x 22.2	6.4 x 6.8	464	43.1	9	2.7
Tantalus	38	16-24	16	14	32	40	n/a	17.6 x 29.9	5.9 x 9.1	526	48.9	9	2.7
Valley Foyer	n/a	n/a	n/a	n/a	n/a	n/a	9	n/a	n/a	2,925	271.7	10	2.9
Wedgemount	70	20-30	24	22	48	60	n/a	35.8 x 22.2	10.9 x 6.8	795	73.8	9	2.7
Wedgemount A	30	10-15	12	10	24	30	n/a	17.6 x 22.2	5.4 x 6.8	391	36.3	9	2.7
Wedgemount B	30	10-15	12	10	24	30	n/a	18 x 22.2	5.5 x 6.8	402	37.3	9	2.7