

WHISTLER CONFERENCE CENTRE

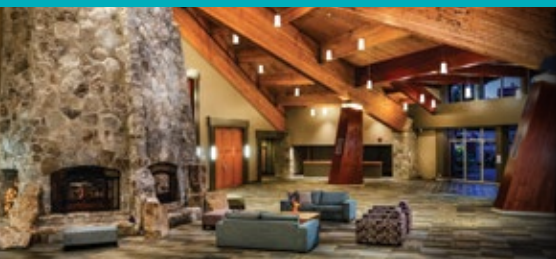

AN UNCOMPROMISING FACILITY
FOR HOSTING UNFORGETTABLE EVENTS



WHISTLER CONFERENCE CENTRE

UPPER LEVEL

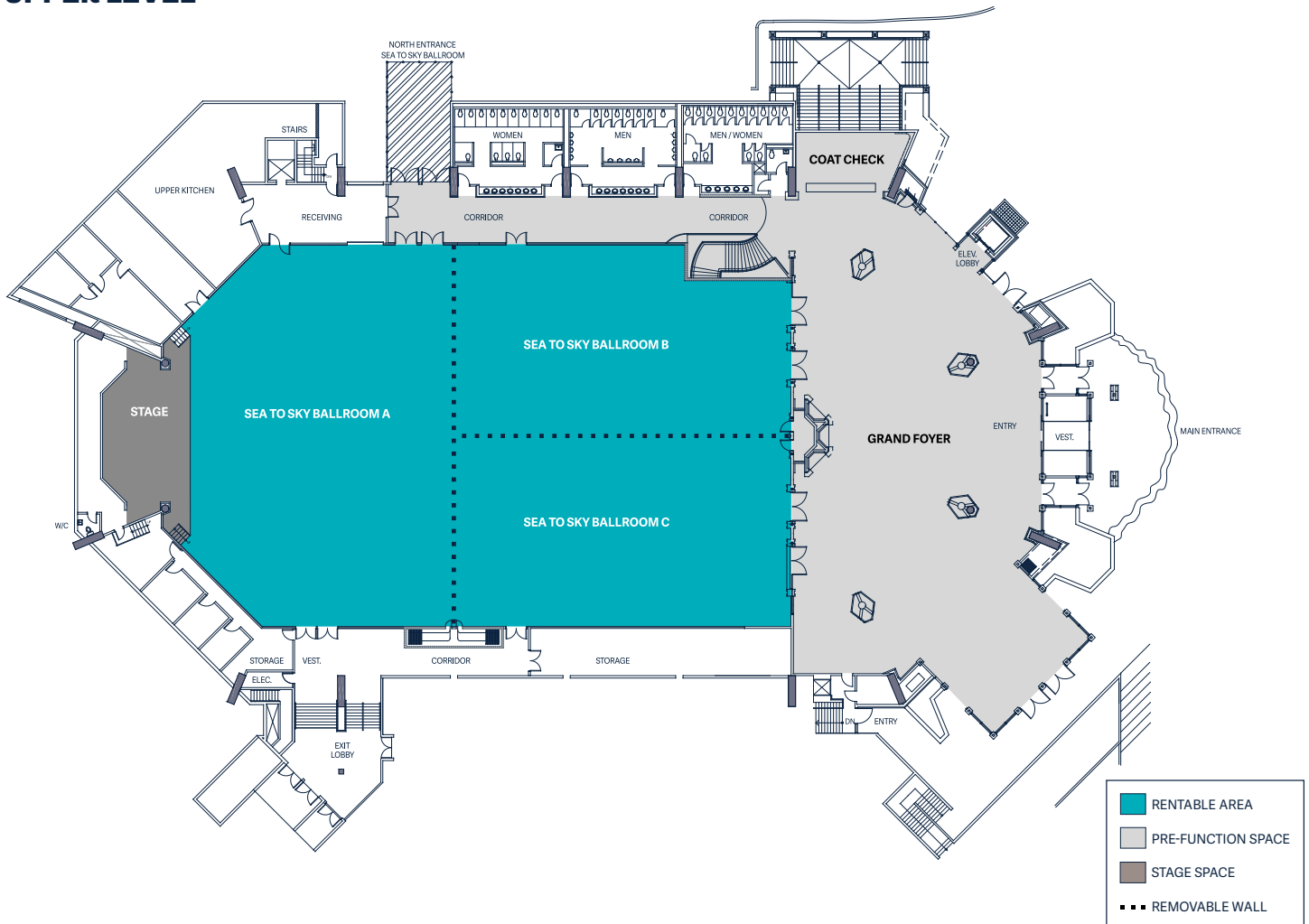

Room	Theatre-style	Classroom 2-3 per table	Boardroom Hollow Sq.	Banquet (Plated) Round x8	Exhibit Booth 8x10	Reception	Dimensions		Area		Ceiling Height			
							Feet	Metres	Sq. Feet	Sq. Metres	Feet	Metres		
SEA TO SKY BALLROOM	1,600	644-966	n/a	n/a	1,056	1,320	100	1,600	164.5 x 104.5	50.1 x 31.9	16,500	1,532.9	15/32	4.5/9.6
Sky Ballroom A	680	252-378	n/a	n/a	432	540	42	690	70.11 x 104.5	21.4 x 31.9	7,032	653.3	15/32	4.5/9.6
Sky Ballroom B	440	168-252	n/a	n/a	296	370	27	440	93.2 x 52.1	28.4 x 15.9	4,565	424.1	15/32	4.5/9.6
Sky Ballroom C	470	168-252	n/a	n/a	312	390	27	470	93.2 x 52	28.4 x 15.9	4,845	450.1	15/32	4.5/9.6
Sky Ballroom B/C	920	392-588	n/a	n/a	600	750	54	920	93.2 x 104.5	27.8 x 31.9	9,410	874.2	15/32	4.5/9.6
Stage Area	n/a	n/a	n/a	n/a	n/a	n/a	n/a	n/a	24 x 36	7.3 x 11	864	80.3	11/17	3.6/5.2
GRAND FOYER*	525	n/a	n/a	n/a	364	460	19	800	56 x 116	17.1 x 35.4	6,530	606.7	15/32	4.5/9.6
COAT CHECK	n/a	n/a	n/a	n/a	n/a	n/a	n/a	n/a	7.5 x 23	2.2 x 6.6	172.5	14.52	n/a	n/a

UNDER ONE ROOF

- 65,000 square foot facility
- 40,000 square feet of rentable meeting space
- 16,500 square foot ballroom
- 8,700 square feet of pre-function space
- 2 built-in raised stages
- 250 seat state-of-art theatre
- 13 breakout rooms
- 32 foot ceilings
- Conference Centre wide wireless internet access
- Direct access to underground parking

WCC Totals	Area	
	Sq. Feet	Sq. Metres
Total Facility	63,475	5,899.20
Total Rentable Space (incl. pre-function areas)	38,092	3,538.80

*Grand Foyer features Rumford Fireplace; has four pillars
**Valley Foyer has two pillars

LOWER LEVEL

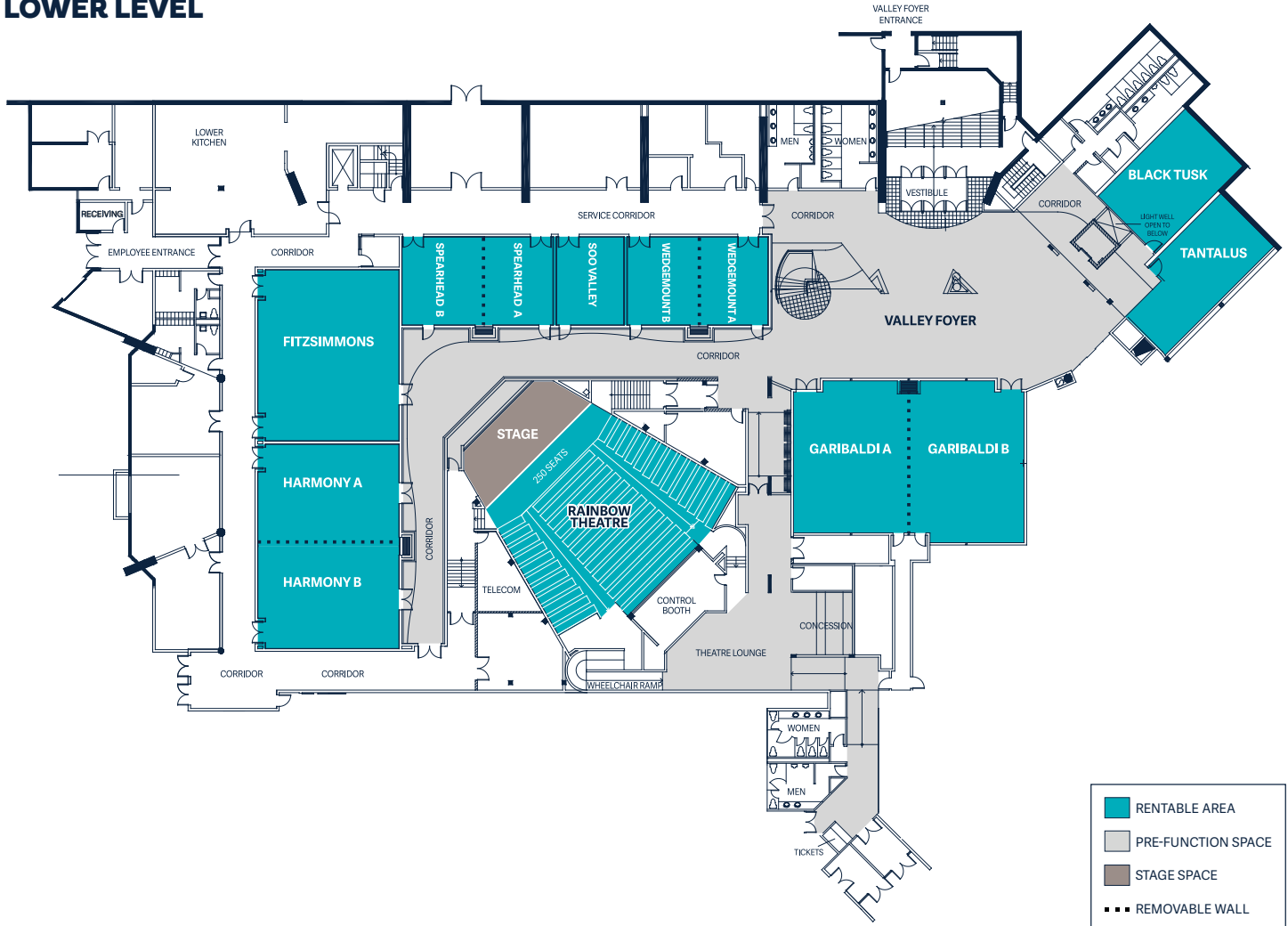

Room	Theatre-style	Classroom 2-3 per table	Boardroom		Banquet (Plated)		Exhibit Booth 8x10	Reception	Dimensions		Area		Ceiling Height	
			Hollow Sq.	U-Shape	Round x8	Round x10			Feet	Metres	Sq. Feet	Sq. Metres	Feet	Metres
Black Tusk	n/a	n/a	18	n/a	n/a	n/a	n/a	n/a	20.3 x 31.2	6.2 x 9.5	633	58.8	8	2.4
Fitzsimmons	135	60-90	48	46	88	110	n/a	155	35.11 x 43	10.7 x 13.1	1,510	140.3	9	2.7
Garibaldi	200	100-150	60	58	144	180	n/a	228	40 x 60	12.2 x 18.3	2,308	214.4	10	3
Garibaldi A	98	40-60	30	28	72	90	n/a	111	29.4 x 38.11	9 x 11.6	1,120	104.1	10	3
Garibaldi B	102	40-60	30	28	72	90	n/a	117	28.5 x 41.5	8.7 x 12.6	1,183	109.9	10	3
Harmony	160	76-114	50	48	96	120	n/a	184	35.11 x 52.3	10.7 x 15.9	1,836	170.6	9	2.7
Harmony A	72	24-36	24	22	48	60	n/a	92	35.11 x 26	10.7 x 7.9	913	84.8	9	2.7
Harmony B	72	24-36	24	22	48	60	n/a	92	35.11 x 26	10.7 x 7.9	913	84.8	9	2.7
Rainbow Theatre	250	250	n/a	n/a	n/a	n/a	n/a	n/a	n/a	n/a	3,300	306.6	17	5
Stage Area	n/a	n/a	n/a	n/a	n/a	n/a	n/a	n/a	13.9 x 38	4.2 x 11.6	528.2	48.7	14	4.2
Soo Valley	20	10-15	12	10	24	30	n/a	38	16.8 x 22.1	5.1 x 6.7	371	34.5	9	2.7
Spearhead	70	20-30	26	24	48	60	n/a	86	38.6 x 22.2	11.8 x 6.8	857	79.6	9	2.7
Spearhead A	30	10-15	12	10	24	30	n/a	39	17.6 x 22.2	5.4 x 6.8	391	36.3	9	2.7
Spearhead B	30	10-15	14	12	24	30	n/a	50	20.9 x 22.2	6.4 x 6.8	464	43.1	9	2.7
Tantalus	38	16-24	16	14	32	40	n/a	66	17.6 x 29.9	5.9 x 9.1	526	48.9	9	2.7
Valley Foyer**	n/a	n/a	n/a	n/a	n/a	n/a	n/a	385	n/a	n/a	2,925	271.7	10	2.9
Wedgemount	70	20-30	24	22	48	60	n/a	80	35.8 x 22.2	10.9 x 6.8	795	73.8	9	2.7
Wedgemount A	30	10-15	12	10	24	30	n/a	39	17.6 x 22.2	5.4 x 6.8	391	36.3	9	2.7
Wedgemount B	30	10-15	12	10	24	30	n/a	40	18 x 22.2	5.5 x 6.8	402	37.3	9	2.7

WHISTLER EVENTS: TRULY INSPIRING

Meetings are about the synergy of your best and brightest, together, under one roof. The centrally located Whistler Conference Centre is the signature group venue in Whistler, BC. Our seasoned team can wire a general session for 1,500, drive a car into the ballroom, or tent and cater a gala dinner to deliver a mountain of inspiration. With over 40,000 square feet of versatile meeting space, set against a coastal mountain backdrop, we've got all that it takes to guarantee a great gathering.

#1 MOUNTAIN RESORT IN NORTH AMERICA

Unique Pedestrian Village: Whistler's key attractions and accommodation are all within walking distance from the Conference Centre, making it easy to stretch your legs, clear your head and take in some fresh air between sessions.

Shopping, Dining and Nightlife: More than 150 restaurants, 200 retail stores and a legendary nightlife and après scene concentrated within walking distance mean there's no shortage of entertainment during down time.

Award-Winning Hotels: Over 5,400 lodging rooms and the only AAA Five-Diamond Resort in Canada make finding the perfect accommodation easy.

Unforgettable Activities: When you're ready to break out of your meetings, Whistler is waiting. Energise your delegates with a few laps in the best mountain bike park in the world. Opt for a morning of golf on one of four championship courses or head up the mountains for a taste of what makes skiing and snowboarding here world-renowned. Stimulate the senses with a hike, treetop adventure or spa break. Invigoration is guaranteed.

WORLD-CLASS FACILITIES

Versatile Ballroom: The largest ballroom in Whistler at over 16,500 sq/ft, with a 900 sq/ft stage and over 100 rigging points, means endless creative opportunities for your event. We're in the business of executing wild and wonderful ideas—we've hoisted cars, hosted circus productions, installed ice-skating rinks and staged rockstar-worthy theatrics.

Grand Foyer and 40 ft. Fireplace: Purpose-designed with events in mind, the Whistler Conference Centre delivers a mood-setting ambience, whether you're hosting a show-stopping gathering in the naturally-lit Grand Foyer or an intimate clustering around the river-rock fireplace.

Scratch Kitchen: Our Executive Chef is dedicated to using locally grown, fresh products and focuses on seasonal cuisine.

Newly Renovated Theatre: Home of the annual Whistler Film Festival, the newly renovated 250-seat Rainbow Theatre boasts raised, built-in staging and the latest in theatre lighting, audio and digital video technology.

The Art of Tech: Advanced fibre optic communication technology worthy of top quality presentations and centre-wide wireless internet keep your people connected and riveted. Webcasting and video conferencing facilities let you expand your reach beyond the resort, broadening the impact of your meeting to inspire even those who couldn't make it in person. And it all comes with in-real-life tech support from our in-house experts, who are always standing by.

LOCAL INSPIRATION

Engaging Local Speakers: Tap into a wellspring of local Olympians, adventurers and entrepreneurs to motivate and inspire your attendees.

Sustainability and Community: Whistler is a leader in environmental practices and is proudly the only destination in Canada with four APEX/ASTM Certifications; Conference Centre, F&B Supplier, A/V Supplier & CVB/Destination. Also a certified member of the Green Meeting Industry Council (GMIC), the Whistler Conference Centre is earth-friendly and part of a community-wide push towards sustainability.

World-Class Destination Management Companies: When you're in need of professional assistance, Whistler's got a roster of creative and customized event planners who know how to bring a great show together.

Olympic Legacy: After serving as the Accredited Media Centre for the 2010 Olympic and Paralympic Winter Games in Whistler, we're pretty comfortable in saying that no meeting is too big, and no detail too small, for us to take on.

Our Team: Our experienced staff are wow-makers at heart. We love this place, and like nothing more than watching other people fall in love with it too. Our mission is to make sure every detail of your program goes perfectly.



LET US HELP YOU

Tourism Whistler is a full-service Convention & Visitors Bureau (CVB) and is your one-stop-shop for planning meetings, special events, retreats, tradeshows or any gathering in the spectacular surroundings of Whistler. The Conference Centre is managed and operated by Tourism Whistler.

Call 1.855.938.2770 or visit us at whistler.com/meetings.

PHOTOGRAPHERS: Mike Crane, Andrew Doran, Joern Rohde